

Silicon PNP Power Transistors

2SB1015

DESCRIPTION

- With TO-220Fa package
- Collector power dissipation
: $P_C=25W@T_C=25^\circ C$
- Low collector saturation voltage
- Complement to type 2SD1406

APPLICATIONS

- For audio frequency power amplifier applications

PINNING

PIN	DESCRIPTION
1	Emitter
2	Collector
3	Base

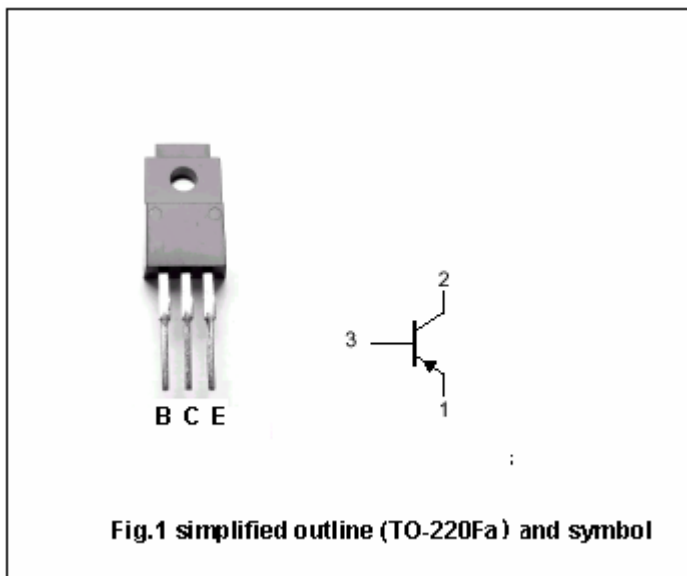

Absolute maximum ratings($T_a=25^\circ C$)

SYMBOL	PARAMETER	CONDITIONS	VALUE	UNIT
V_{CBO}	Collector-base voltage	Open emitter	-60	V
V_{CEO}	Collector-emitter voltage	Open base	-60	V
V_{EBO}	Emitter-base voltage	Open collector	-7	V
I_C	Collector current		-3	A
I_B	Base current		-0.5	A
P_C	Collector power dissipation	$T_a=25^\circ C$	2.0	W
		$T_C=25^\circ C$	25	
T_j	Junction temperature		150	$^\circ C$
T_{stg}	Storage temperature		-55~150	$^\circ C$

Silicon PNP Power Transistors

2SB1015

CHARACTERISTICS

T_j=25℃ unless otherwise specified

SYMBOL	PARAMETER	CONDITIONS	MIN	TYP.	MAX	UNIT
V _{CEO(BR)}	Collector-emitter breakdown voltage	I _C =-50mA; I _B =0	-60			V
V _{CEsat}	Collector-emitter saturation voltage	I _C =-3A; I _B =-0.3A			-1.7	V
V _{BE}	Base-emitter voltage	I _C =-0.5A; V _{CE} =-5V			-1.0	V
I _{CBO}	Collector cut-off current	V _{CB} =-60V; I _E =0			-100	μA
I _{EBO}	Emitter cut-off current	V _{EB} =-7V; I _C =0			-100	μA
h _{FE-1}	DC current gain	I _C =-0.5A; V _{CE} =-5V	60		200	
h _{FE-2}	DC current gain	I _C =-3A; V _{CE} =-5V	20			
f _T	Transition frequency	I _C =-0.5A; V _{CE} =-5V		9		MHz
C _{OB}	Collector output capacitance	f=1MHz; V _{CB} =-10V		150		pF

Switching times

t _{on}	Trun-on time	R _L =15Ω; V _{CC} =-30V I _{B1} =-I _{B2} =-0.2A Duty cycle≤1%		0.4		μs
t _s	Storage time			1.7		μs
t _f	Fall time			0.5		μs

◆ h_{FE-1} Classifications

O	Y
60-120	100-200

Silicon PNP Power Transistors

2SB1015

PACKAGE OUTLINE

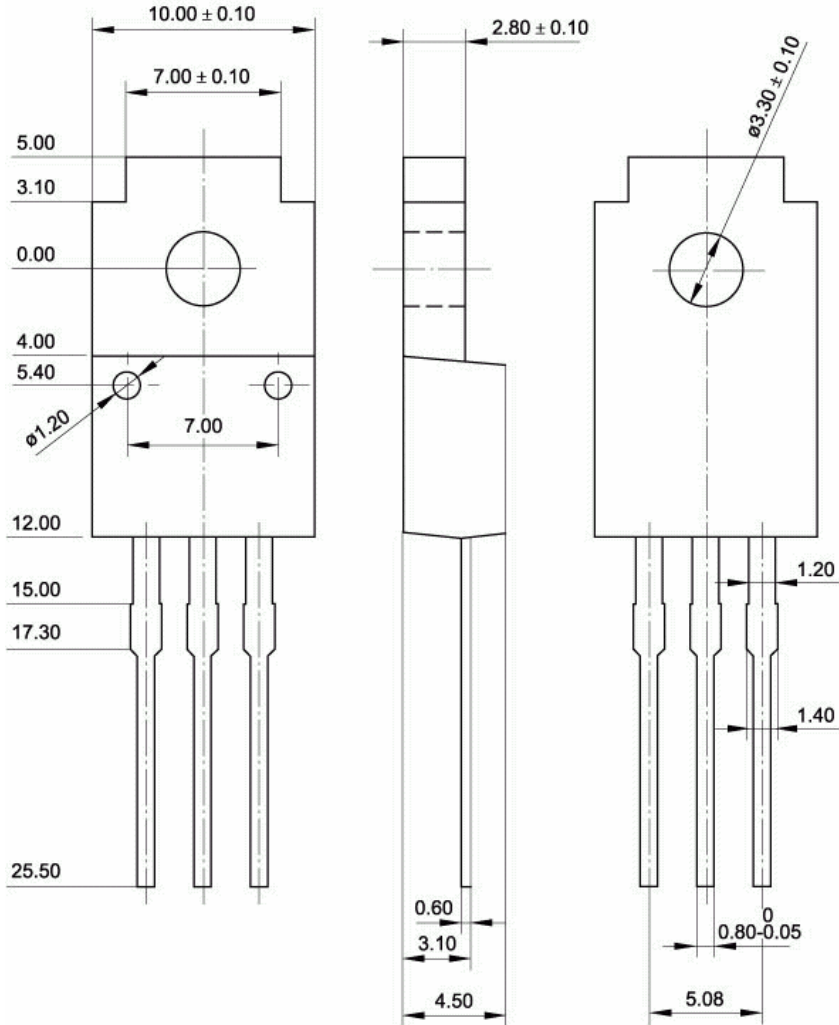

Fig.2 Outline dimensions (unindicated tolerance: ± 0.15 mm)

Silicon PNP Power Transistors

2SB1015

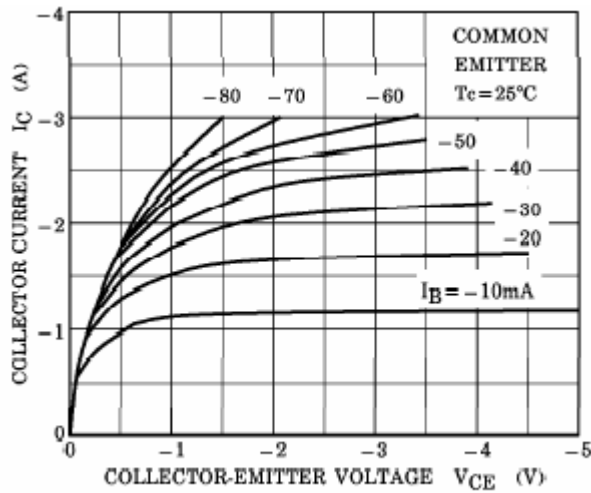

Fig.3 Static Characteristic

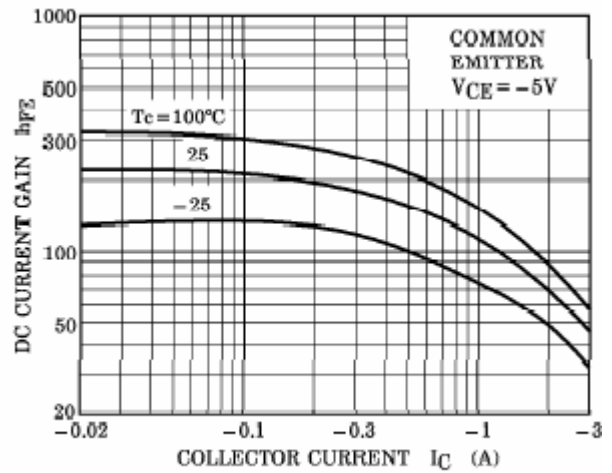

Fig.4 DC current Gain

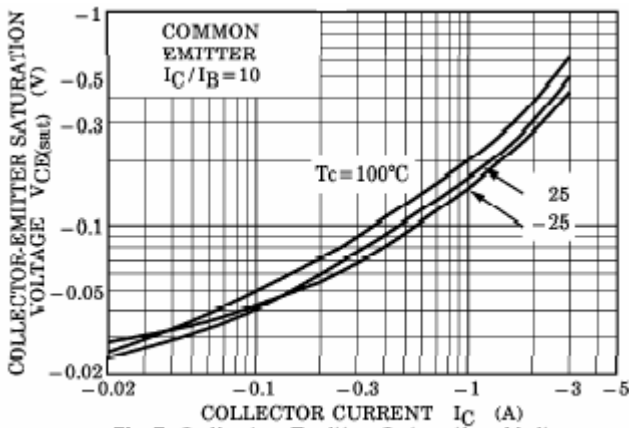

Fig.5 Collector-Emitter Saturation Voltage

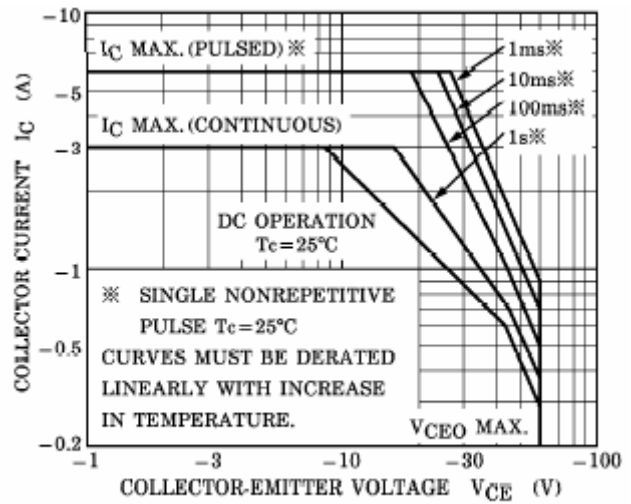

Fig.6 Safe Operating Area